



Range of roof mounted mixed flow fans, specially designed for the extraction of potentially hazardous and explosive gases, manufactured from sheet steel protected with black polyester paint coating (except TH-800/200 manufactured from plastic to prevent retention of static electricity, base and cap manufactured from sheet steel protected with black polyester paint coating). Bird-proof guard. Detachable fan unit without demounting duct connections.

**Motors**

- Single phase 230V-50Hz.
- IP44, Class B.
- Increased safety Ⓢ II2G EExeIIT3 Gb  
For models 250 and 315:  
EC nr. LOM 11ATEX2021 X, Supplement 1.
- Increased safety Ⓢ II2G EExeIIT3  
For model 800: EC nr. LOM 08ATEX2052 X, Supplement 2.



**IP55, external terminal box**  
External terminal box, easy access, IP55, fireproof plastic V0.



**ATEX capacitor.**

**Specific applications**



**TECHNICAL CHARACTERISTICS**

Model	Speed (rpm)	Maximum absorbed power (W)	Maximum absorbed current (A)	Maximum airflow (m³/h)	Working temperature (°C)	Sound pressure level* (dB(A))		Weight (kg)
						Inlet	Outlet	
TH-800/200 EX	2450	120	0,50	800	-20/+40	58	59	8
TH-1100/250 EX	2630	197	0,85	965	-20/+40	55	63	22
TH-1200/315 EX	2600	170	0,74	1150	-20/+40	52	56	28

\* Sound pressure level, measured at 3 m in free field conditions, at point "A" of the performance curve.

## PERFORMANCE CURVES

- $q_v$ : Airflow in  $m^3/h$  and  $m^3/s$ .
- $p_{sf}$ : Static pressure in mmWG and Pa.
- Dry air at 20°C and 760 mmHg.
- Performance data in accordance with ISO 5801 and AMCA 210-99 Standards.
- LwA: Sound power level measured at inlet and outlet in dB(A).

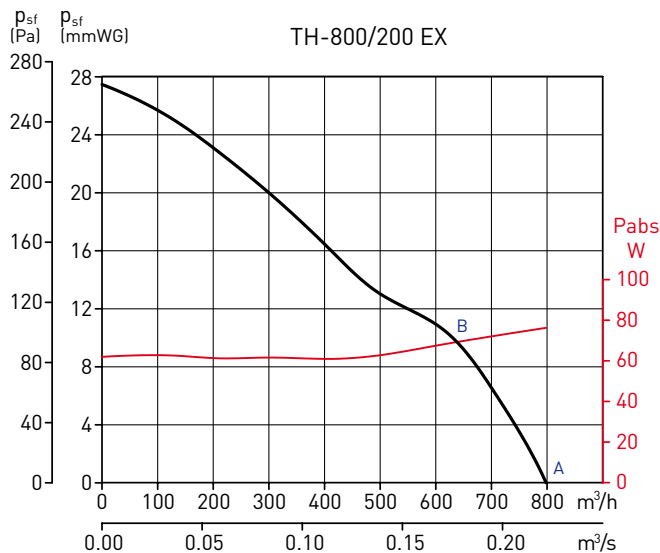

TH-800/200 EX		63	125	250	500	1.000	2.000	4.000	8.000	LwA
Inlet	A	19	44	64	73	75	70	65	57	78
	B	25	53	67	75	76	71	64	55	80
Outlet	A	42	51	64	76	75	72	66	57	80
	B	39	56	69	80	78	72	64	55	83

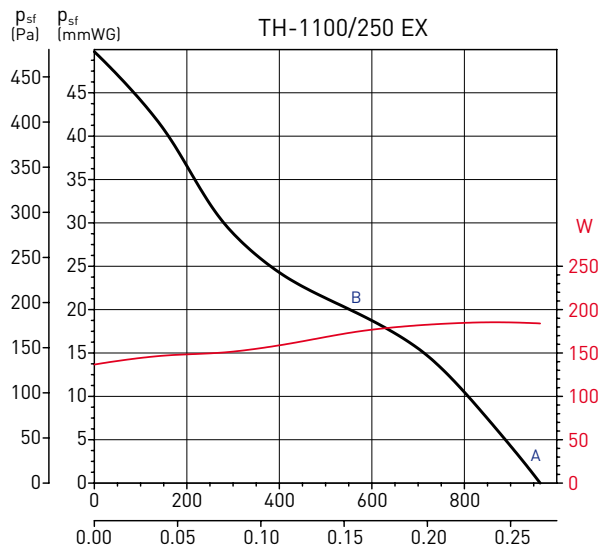

TH-1100/250 EX		63	125	250	500	1.000	2.000	4.000	8.000	LwA
Inlet	A	40	51	64	68	69	72	63	57	75
	B	39	53	68	69	67	68	62	54	74
Outlet	A	54	55	68	78	80	78	67	58	84
	B	39	53	69	75	76	74	66	57	80

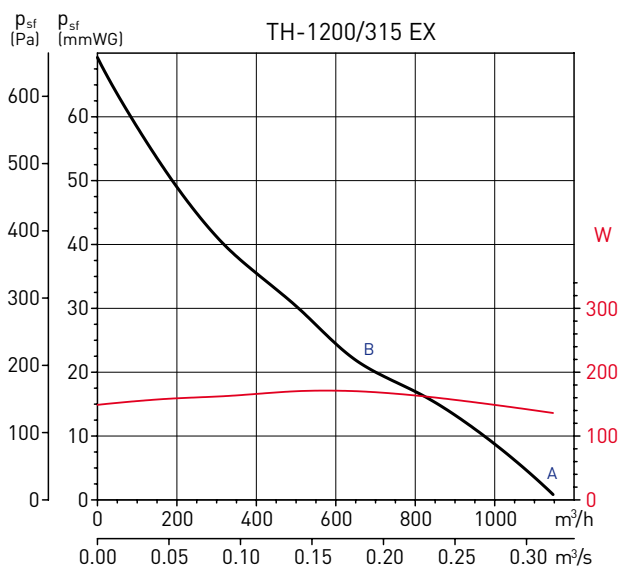

TH-1200/315 EX		63	125	250	500	1.000	2.000	4.000	8.000	LwA
Inlet	A	29	45	61	62	68	68	62	56	72
	B	39	49	70	66	68	69	62	56	75
Outlet	A	42	52	66	70	74	66	64	56	77
	B	38	44	74	72	72	72	65	56	79

**DIMENSIONS (mm)**

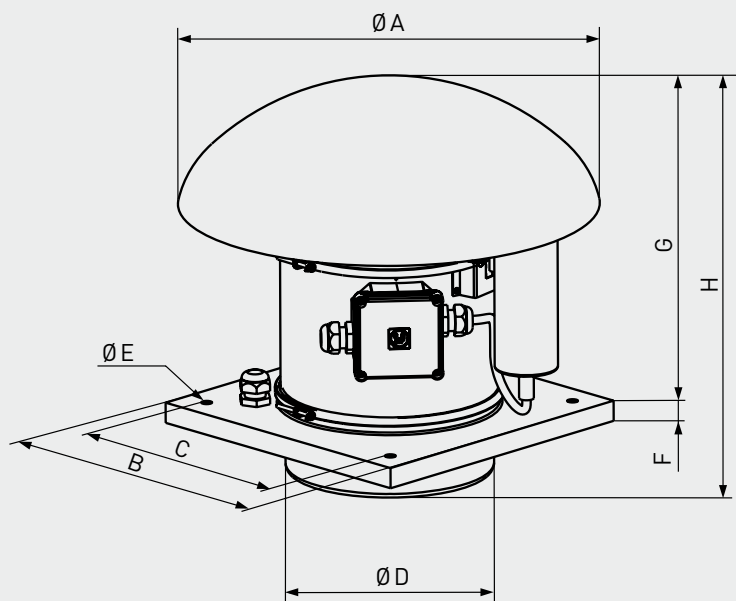

Model	A	B	C	D	E	F	G	H
TH-800/200 EX	400	300	245	197,5	10,5	20	312	377
TH-1100/250 EX	546	435	330	248	12	20	372	457
TH-1200/315 EX	735	560	450	312	12	20	450	544

**SPECIFIC ACCESSORY**



**ACOPEL EX N**  
Explosion proof  
flexible connection.

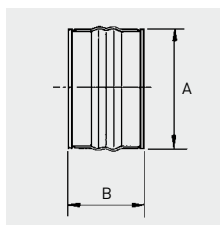

Model	Model connection	ØA	B
TH-800/200 EX	ACOPEL EX-200/160 N	200	160
TH-1100/250 EX	ACOPEL EX-250/160 N	250	160
TH-1200/315 EX	ACOPEL EX-315/160 N	315	160

For more information see mounting accessories.